

## Horizontal Motor With Cast Iron Frame

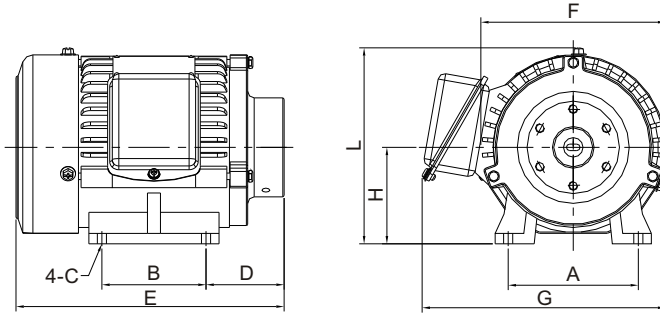

HP	A	B	C	D	E	F	G	H	L	Mark
1/4	100	80	Ø8	60	210	140	185	60	135	J
	100	80	Ø7	60	206	142	187	74	150	S
1/2	125	100	Ø10	74	257	174	225	80	175	J
	125	100	Ø10	68	246	175	225	80	173	S
1	125	100	Ø10	80	270	174	225	80	175	J

## Vertical Motor With Cast Iron Frame



HP	A	B	C	D	E	F	L	Mark
1/4	Ø158	Ø140	3-Ø9	191	8.5	192	212	J
1/2	Ø160	Ø140	4-Ø10	208	11	241		J
	Ø157	Ø130	4-Ø11	215	11	244		S
1	Ø205	Ø180	4-Ø12	239	10	247	248	S

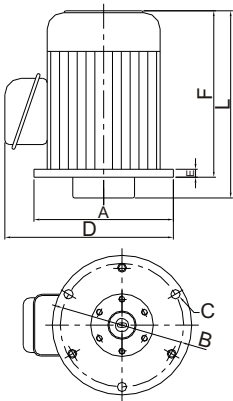

### ◆ Order Code :

PMO - 0 02

0 : Motor HP

01 : 1/8HP  
(Only Horizontal Type)  
02 : 1/4HP  
04 : 1/2HP  
08 : 1HP

D | Voltage  
A : 1Ø110V  
C : 1Ø220V  
D : 3Ø220/380V  
E : 3Ø220/440V  
F : 3Ø208/415V  
G : 3Ø230/460V  
H : 3Ø240/480V  
X : Special Voltage

1 | 1 : Vertical Type  
3 : Horizontal Type

2 | 1 : Steel Plate  
2 : Cast Iron

※ | Special Request

J | Mark J or S  
(Standards: J Type)

## Horizontal Motor With Steel Plate Frame

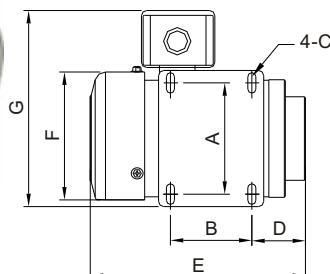
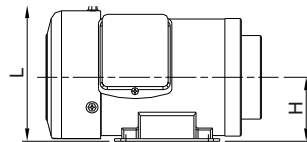

HP	A	B	C	D	E	F	G	H	L	Mark
1/4	100	79	Ø8	62	220	140	187	61	131	J
	100	80	Ø7	52	209	129	175	62	132	S
1/8	70	60	Ø7	51	179	106.5	160	56	105	S

※ In millimeter unless otherwise stated.